

North Entrance

FPC plans on adding over 1,350 sq. ft. at the north side of our building to expand our current M & M Café gathering area and add a NEW exterior canopy, airlock entrance, coat room, and lobby.

Elevator & Lift

Also located at the north side of the building will be a newly installed elevator allowing easier access to the Lower Level. A vertical platform lift will also be installed allowing barrier free access between the Narthex and the Chancel.



Gathering Spaces

The Fellowship Hall will receive new recreation friendly, easy to clean flooring. A prayer Labyrinth will be created allowing the space to be used for a variety of spiritual and recreational activities. Our Classroom, Worship Centers, and Youth Room will be updated. A small parlor on the main level will be created by repurposing a children in worship space.



Rest Rooms

The Rest Rooms located on the Lower Level will get a make-over, including an additional sink in the Women's Room and accessories to create a more welcoming feel. A Family Rest Room will be added with an accessible toilet, sink, shower, washer and dryer.

Fresh Paint & Furnishings

The project area will get a fresh look. Many areas will receive new ceiling tiles, updated flooring, and attractive wall finishes. Some spaces will be filled with newly purchased modern furnishings that are both comfortable and versatile.



Storage

The robe racks currently located on the Main Level just outside the sanctuary will be moved to a newly designated Arts and Worship Room. On the Lower Level, walls will be reconfigured to increase the storage for tables and chairs. New closets and cabinets will be added for our ministry partners to store their paraphernalia.

Security & Technology

FPC plans on increasing our security in various ways, including installing a security camera at the front entrance. We will improve the WIFI access in the Lower Level and install a loop system in the Fellowship Hall.

Stairs

The South Stairwell will be updated to increase natural light.



LOWER LEVEL

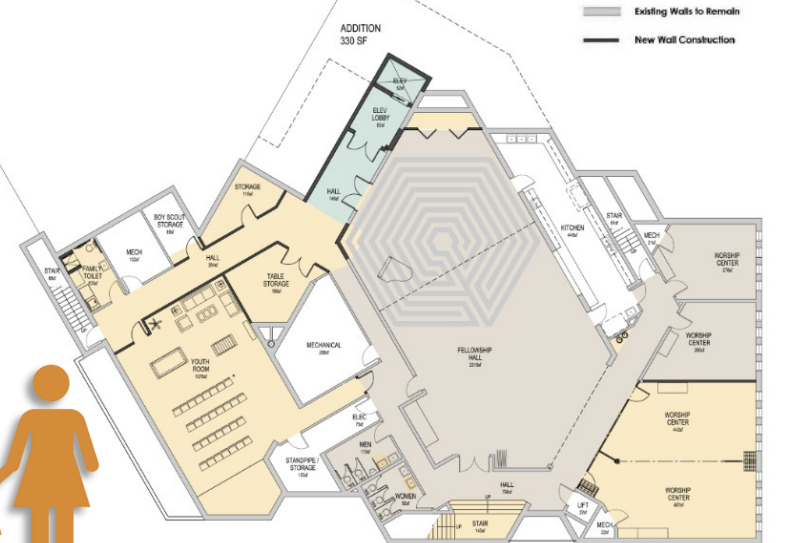

- Existing Building No Work
- Existing Building Updated Finishes
- Existing Building Renovated Area
- Addition New Construction
- Existing Walls to Remain
- New Wall Construction